



User Manual





Alb Filter[®] **Element**

...natürlich besser Wasser

Thank you very much for purchasing our Alb Element water filter

For a proper installation and efficient operation of the filter, please observe the following installation instructions for the particular installation locations.

Explanation of pictograms

-  Increased attention required
-  Additional information
-  Note
-  Tool required



Content

Preamble	4
Scope of delivery	5
Parts - Alb Filter [®] Element.....	6
Installation shower / bathtub	8
Installation under sink	12
Replacing the filter cartridge	16
Maintenance	20
Technical Specifications	21
General safety instructions.....	22
Special safety instructions for interiors	24
Notes for cartridge change.....	25

Preamble

Alb Filter - a matter of the heart.
We are pleased that you have chosen Alb filter.

Since 2001 we can look back on a great experience in the field of water treatment.

At a time when even the smallest part seems to come from the Far East, we at Alb Filter stand for quality from the centre of the Swabian Alb. A production site in southern Germany, which is characterized by the highest standards and precision in many areas.

We are committed to our region and manufacture our products with our partners in the immediate vicinity.

A real piece of home - **Made in Germany.**



Scope of delivery

i Note:

Before commissioning, please check whether the delivery is complete - it consists of:

- **Alb Element filter housing**
- **Alb Element filter cartridge (already installed)**

Further accessories as well as replacement cartridges, spacers and discount campaigns can be found under:

www.alb-filter.com

Parts - Alb Filter® Element



1. Top connection (inlet): 1/2 inch female thread with head seal
2. Spanner size 24 mm for open-end wrench (top)
3. Sealing ring (top)
4. Thread for upper housing cover
5. Filter corpus with internal thread at top and bottom
6. Thread for lower housing cover
7. Sealing ring (bottom)
8. Spanner size 24 mm for open-end wrench (bottom)
9. Bottom connection (outlet): 1/2 inch external thread

Installation shower / bathtub

i Note:

Alb Filter cartridges for shower applications are generally suitable for **hot and cold** water. For water connections that are located directly on the wall or the distance of the connector to the wall is **less than 35 mm**, a distance adapter is necessary.

 Available at www.alb-filter.com
Shop Category: Accessories

1. Wall
2. Connector

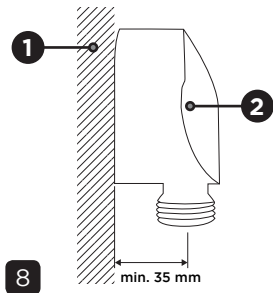

Way of proceeding:

1. Before starting installation, please close the water supply line on the relevant fitting.
2. Unscrew the shower hose from your tap. (Picture 2a)
3. Remove the filter housing from its packaging.

✔ The cartridge is already installed in the housing.

⚠ Observe the direction of water flow, marked with the arrow and „IN“! (Picture 1a)



2a



3a



4. Afterwards screw the filter housing to the external thread of your fitting. (Picture 3a)
5. Tighten the housing by hand.
6. Then screw the previously unscrewed shower hose to the bottom end of the filter housing.
7. Check that the connections are correctly seated.
8. Slowly open the tap up to 1/3 and let the water run through the filter for 1 min to activate the cartridge for operation.

i Fine activated carbon dust can dissolve and slightly turbidify the water during the activation process of the cartridge.

9. Check the filter housing and all connected components for leaks.
10. The Alb filter is now ready for use. (Picture 4a)



Installation under sink

⚠ Warning:

For installations under sinks and other indoor areas in the household, a water stop system must be installed upstream. This protection serves to stop the flow of water in the event of water leaks at the housing. If you have any questions, please contact your plumber.

Way of proceeding:

1. Before starting the installation, please close the water supply on the relevant valve. (Picture 1b)
2. Unscrew the cold water supply hose of your angle valve. (Picture 2b)
3. Remove the filter housing from its packaging.

✓ The cartridge is already installed in the housing.

⚠ Please observe the direction of water flow, marked with the arrow and „IN“! (Picture 6b)

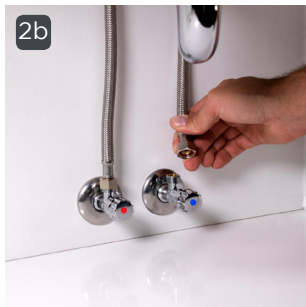
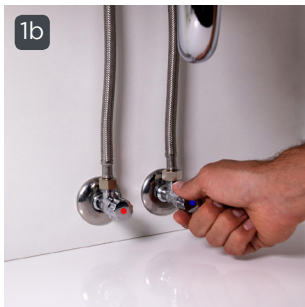

4. Now screw a Flex hose connection onto the angle valve (see: Further accessories). (Picture 3b)
5. Then fit the filter housing between the Flex hose connection of the angle valve and the supply line to the fitting. Use an adapter if necessary. (Picture 4b & 5b)

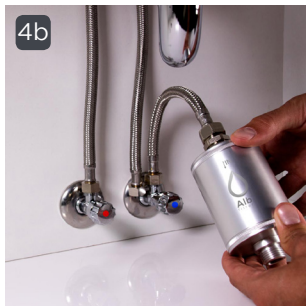
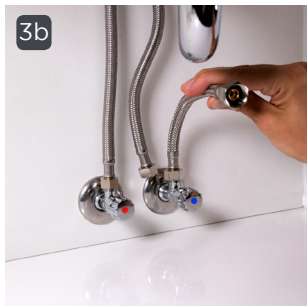

6. Check that the connections are correctly seated.
7. Slowly open the tap up to 1/3 and let the water run through the filter for 1 min to activate the cartridge for operation.

i Production-related activated carbon dust can loosen during rinsing and slightly turbidify the water during the activation process of the cartridge.

8. Check the filter housing and all connected components for leaks.

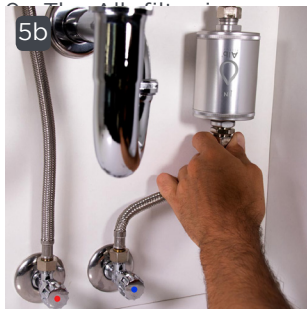

ready for

6b



Replacing the filter cartridge

Way of proceeding:

1. Before starting the installation, please close the water supply line on the relevant valve.
2. Unscrew the filter housing from the fitting or the Flex hose connection.
3. Depending on the cartridge version, open the upper or lower cover. (Picture 1c)



🔧 If the housing cover is stuck, please use a 24 mm open-ended spanner. Use a sheet to avoid scratches.

4. After opening the lids, the filter cartridge is visible. (Picture 3c & 4c)

ⓘ Depending on the cartridge type, removal is done according to procedure **A.** or **B.**



Procedure A.

Open the top lid.

Turn the filter housing with the opening downwards, the cartridge falls out. Then insert the new cartridge into the filter housing with the seal facing upwards.

Please note the direction of flow. (Picture 5c)

Procedure B.

Open the bottom lid.

These cartridges are fitted with a press fit in the bottom of the case. Carefully pull the cartridge out of the press fit with slight movements. Insert the new cartridge into the filter housing with the holder facing downwards. Press them into the bottom of the housing. (Picture 6c)

i Note:

Avoid placing the covers at an slanted angle on the threads, as this could damage them. Check the tightness of the filter housing after each filter change.

3. Close the housing cover again.
4. The Alb filter is now ready for use again.

5c

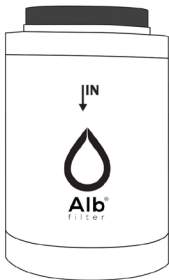

6c



Maintenance

The Alb filter is basically low-maintenance. However, the maximum service life of the filter cartridges must be observed.

Clean and lime-free fittings are the prerequisite for hygienically perfect drinking water.

We recommend a cartridge change every 6 months (according to DIN 1988).

Please do not use any chemical agents to clean/decalcify the filter housing. We recommend placing the filter in a lemon solution.

Technical Specifications

- **Version:** Filter housing for installation on water connections
- **Material:** Special alloy, food-safe
- **Cartridge and Performance:**
Depending on the selected version
- **Input connection (top cover):**
1/2 inch female thread
- **Output connection (bottom cover):**
1/2 inch male thread
- **Flow rate:** approx. 5-7 litres per minute - depending on filter cartridge type (at approx. 2-3 bar water pressure)

General safety instructions

- Scope of delivery includes the cartridge selected when ordering. It is already pre-installed in the filter housing.
- All installation work may only be carried out by a suitably trained specialist. Make sure that the water inlet and outlet are installed correctly.
- In the event of improper installation, no liability is assumed for any damage arising.
- Protect from frost.
- The cartridge should be changed after 6 months (according to German DIN 1988).
- An earlier change may be necessary if the water flow is visibly reduced or if the water quality deteriorates.
- An early change is not a defect in the cartridge used, but an indication of an increased occurrence of fine particles in the unfiltered water.
- For use in conjunction with a hot water boiler, please contact your installer.

-
- In exceptional cases, for physical reasons, very cold water can cause condensation water to form in the filter housing for physical reasons.
 - To ensure complete safety regarding the quality of your filtered water, a water analysis in a responsible laboratory is obligatory.

Special safety instructions for interiors

- When installed under the sink, the filter must be properly connected between the angle valve and the cold water supply line of the tap.
- An installation in indoor areas without water drainage always requires a certified check valve or a water stop system to be installed by a specialist (e.g., the brand: Aquastop®).

Notes for cartridge change

Keep track of when the cartridge was inserted and when it should be replaced. According to german DIN 1988 every 6 months.

Start	End	Note

 Replacement cartridges available at
www.alb-filter.com
Shop category: Filter Cartridges

©2018
Pure One UG & Co. KG
Lupfenstraße 1
D-78652 Deisslingen - Germany
www.alb-filter.com
info@alb-filter.com

All rights reserved. No part of this manual may be reproduced in any form or reproduced or processed using electronic, mechanical or chemical processes without the written consent of the publisher.

It is possible that this manual still has printing defects or printing errors. However, the information in this manual is checked regularly and corrections are made in the next issue. We accept no liability for technical or printing errors and their consequences.

All trademarks and industrial property rights are acknowledged. Changes in line with technical progress may be made without prior notice. Illustrations and diagrams are not binding. All brand and product names used serve only to clarify the compatibility of our products with certain products from various other manufacturers and are the property of their respective owners.

V1.0 (06/2018)

